

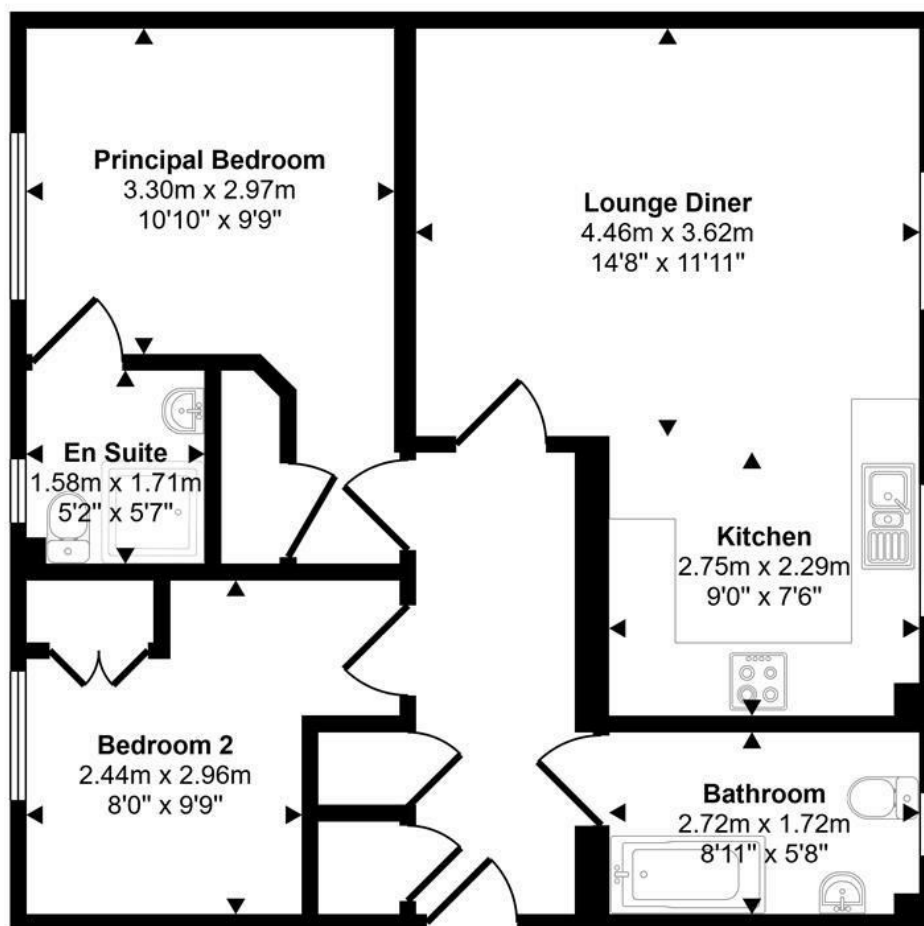

Scott Close | Norwich | NR7  
 Guide £190,000

abbotFox

Approx Gross Internal Area  
 63 sq m / 677 sq ft



Floorplan

This floorplan is only for illustrative purposes and is not to scale. Measurements of rooms, doors, windows, and any items are approximate and no responsibility is taken for any error, omission or mis-statement. Icons of items such as bathroom suites are representations only and may not look like the real items. Made with Made Snappy 360.

Energy Efficiency Rating		Current	Potential
Very energy efficient - lower running costs			
(92 plus) A			
(81-91) B		85	85
(69-80) C			
(55-68) D			
(39-54) E			
(21-38) F			
(1-20) G			
Not energy efficient - higher running costs			
England & Wales		EU Directive 2002/91/EC	

Disclaimer – In accordance with the Property Misdescriptions Act, the company gives notice that all descriptions, references to condition, necessary permissions for use and other details are given in good faith and believed to be correct, but any intending lessees do not rely on them as statements of fact, but must satisfy themselves by inspection or other means, as to their accuracy.



abbotFox presents this exceptional, modern first floor apartment. Set within the popular residential area of Sprowston and within easy reach of a wealth of local amenities, this home affords an exceptional degree of convenience.

Offering a bright and stylish finish throughout, this home has been meticulously improved and well maintained by the current owners. The accommodation is neatly arranged and comprises; entrance hall, open plan lounge kitchen diner, two bedrooms, with an en-suite to the principal bedroom and a family bathroom. The property further benefits from two allocated parking spaces.

An ideal opportunity for any first time buyer, an internal viewing comes highly recommended.

